

FAG

20310-TVP

Barrel roller bearing

Schaeffler ID:
0190140900000Barrel roller bearings 203, main
dimensions to DIN 635-1

Technical information

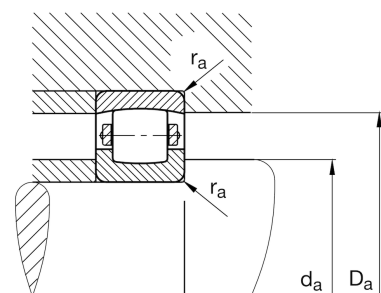
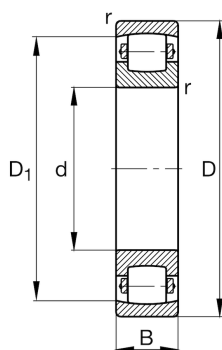
**Main Dimensions & Performance Data**

d	50 mm	Bore diameter
D	110 mm	Outside diameter
B	27 mm	Width
C_r	108,000 N	Basic dynamic load rating, radial
C_{0r}	118,000 N	Basic static load rating, radial
C_{ur}	10,600 N	Fatigue load limit, radial
n_G	5,800 1/min	Limiting speed
	1.138 kg	Weight

Dimensions

r_{min}	2 mm	Minimum chamfer dimension
D_1	94.4 mm	Bore diameter outer ring

Mounting dimensions

$d_{a min}$	61 mm	Minimum diameter shaft shoulder
$D_{a max}$	99 mm	Maximum diameter of housing shoulder
$r_{a max}$	2 mm	Maximum recess radius

Temperature range

T_{min}	-30 °C	Operating temperature min.
T_{max}	120 °C	Operating temperature max.